

Headquarters Open Day

Saturday, 28 June 1986



INTRODUCTION

Welcome to the first Open Day at Eastern Electricity's Headquarters. You will find that a number of special exhibitions and displays have been mounted in the main building and elsewhere on the site and their location is shown in this booklet. We particularly hope that you will take the opportunity to visit the Electric Living Exhibition which is being held in a marquee to the rear of the front lawn.

Eastern Electricity serves 2¼ million customers in an area which covers the whole of East Anglia, Essex, Hertfordshire, suburban North London and parts of Bedfordshire and Buckinghamshire. As well as our main task of distributing and selling electricity, we have thriving businesses in appliance marketing through 122 shops, and in electrical contracting and appliance repair.

Nearly 400 staff are employed at our Headquarters here at Wherstead covering the full range of our activities including Engineering, Marketing, Finance, Administration and Personnel.

SITE PLAN

1. **COTTAGE** — An exhibition on the history of Wherstead village and the Hall compiled by young people on the Youth Training Scheme based at Eastern Electricity together with the Wherstead Parochial Church Council.
2. **STABLE BLOCK** — A listed building converted for office accommodation about ten years ago. Details of the conversion can be found in the booklet 'Wherstead — People and Events Associated with Eastern Electricity' — which is on sale price 20p.
3. **YARD — DISPLAY OF BOARD VEHICLES** — Eastern Electricity have a fleet of some 3,700 vehicles. A number of the specialised vehicles used by our staff are on show in the stable yard.
4. **NEW WHERSTEAD GARAGE** — The new garage was very recently completed and was designed in sympathy with the existing stable block environment. It replaced a building which had been in use since 1948 when it was converted from a former carriage shed.
5. **PRINTING UNIT** — The Printing Unit undertakes much of the Board's requirements for specialised print including publicity material, leaflets and standard forms.
6. **'FARM ELECTRIC' DISPLAY** — Our County Show caravan will demonstrate the advantages of electrical applications in agriculture.
7. **ELECTRIC LIVING EXHIBITION** — You are invited to visit the caravan on the front lawn to see examples of how we are helping the domestic customer, commerce and industry to use electricity wisely and efficiently. Demonstrations of microwave cooking and dishwashing will also be on view.

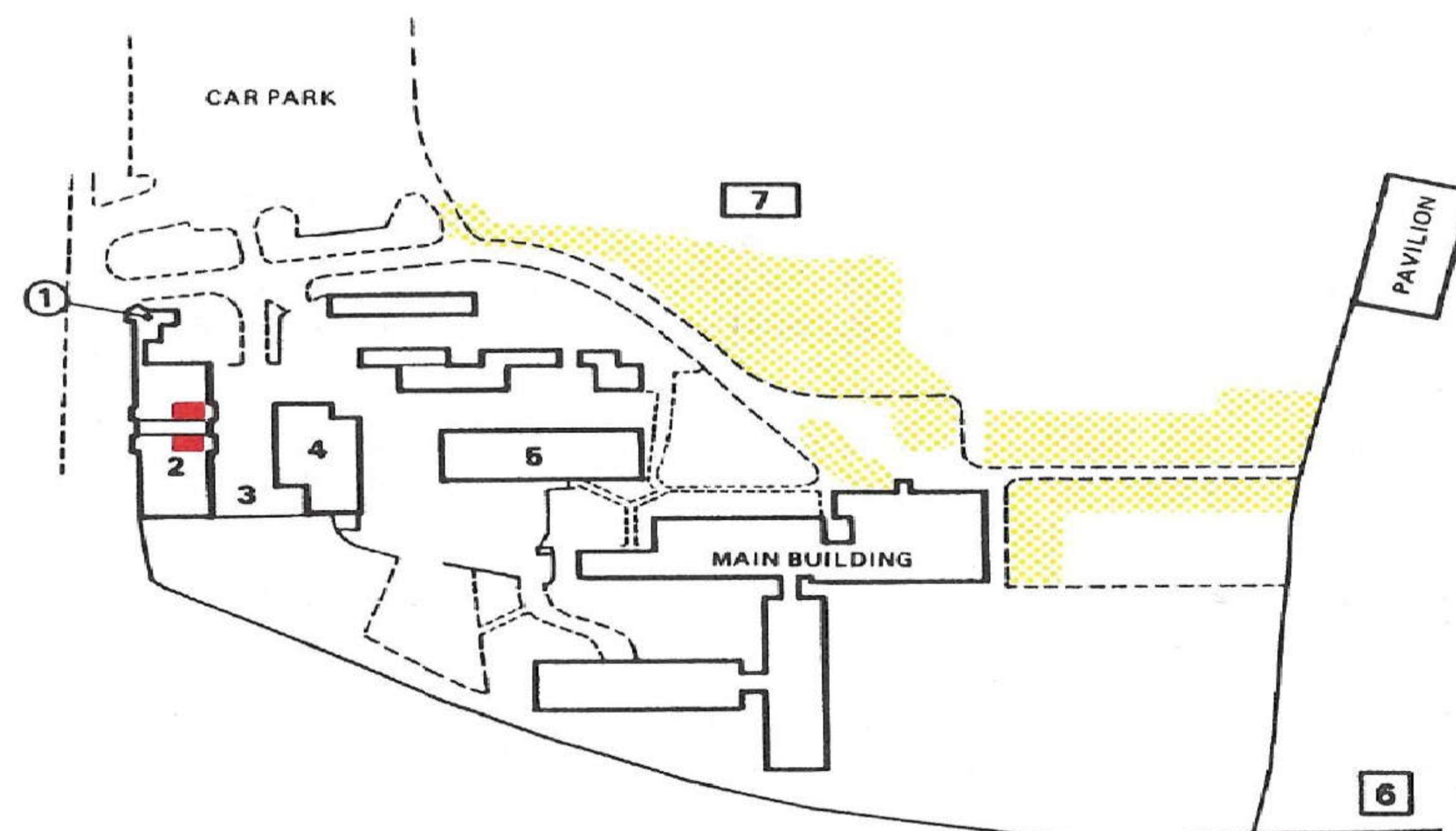

KEY

- 1 — COTTAGE - DISPLAY ON HISTORY OF WHERSTEAD
- 2 — STABLE BLOCK - A LISTED BUILDING CONVERTED TO OFFICE ACCOMMODATION
- 3 — YARD - DISPLAY OF BOARDS VEHICLES
- 4 — NEW WHERSTEAD GARAGE
- 5 — PRINTING UNIT - OPEN TO VISITORS
- 6 — 'FARM ELECTRIC' DISPLAY
- 7 — 'ELECTRIC LIVING' EXHIBITION

COUNTRY FAIR ACTIVITIES

TOILETS

GROUND FLOOR

SAFETY EXHIBITION — LARGE CONFERENCE ROOM

A selection of posters, signs and literature depicting the dangers of working or playing too near substations and overhead lines will be on display.

The video 'Play Safe' which is shown by Eastern Electricity staff to school children will also be running throughout the afternoon.

CEGB DISPLAY - NUCLEAR POWER — STAFF RESTAURANT AREA

The Central Electricity Generating Board are mounting a display showing the safe use of nuclear power. A representative will be on hand to answer questions.

DEMONSTRATION OF WORD PROCESSING SYSTEM — TYPING CENTRE

The Wordplex Central Word Processing installation will be demonstrated during the afternoon.

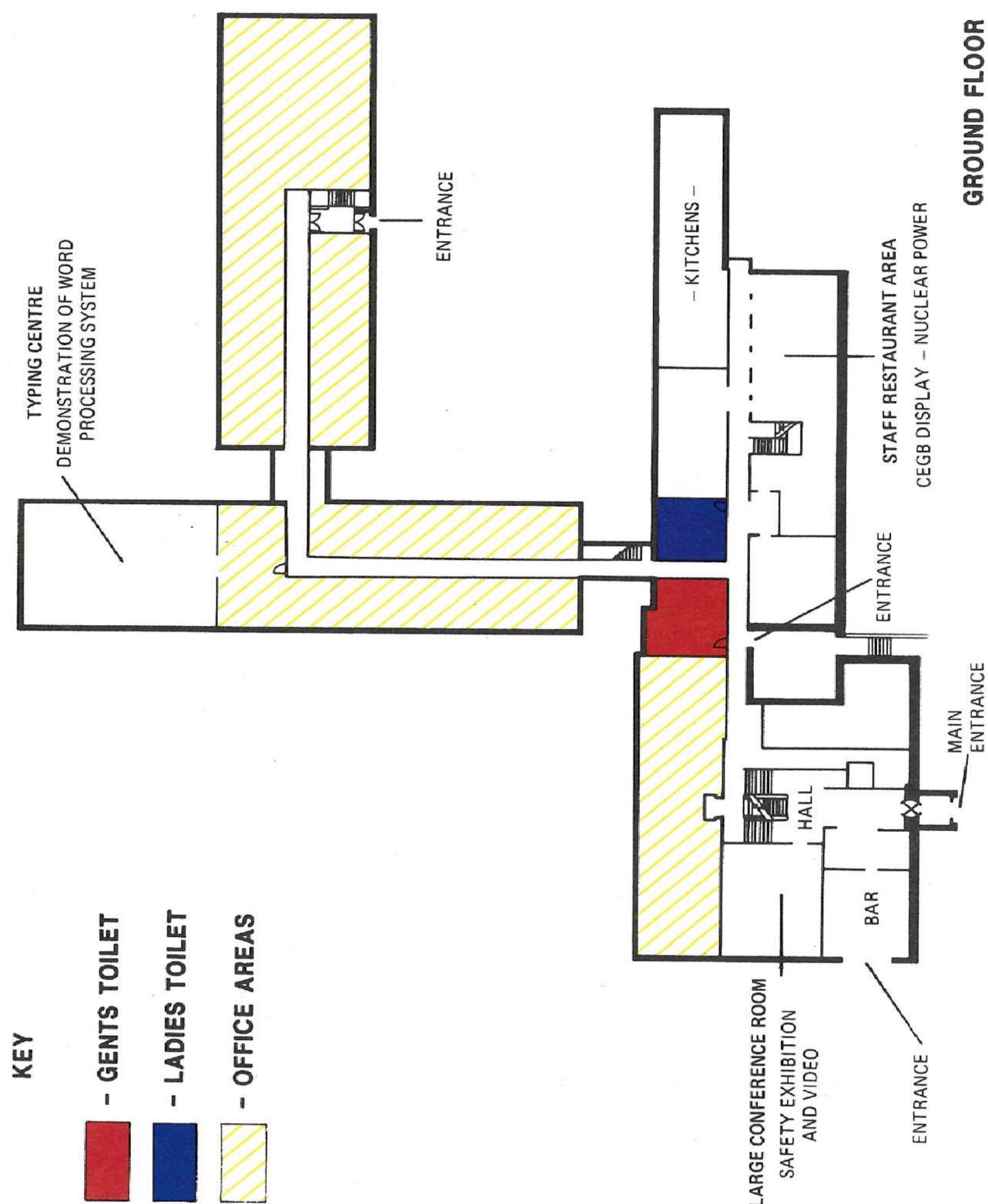

KEY

- GENTS TOILET
- LADIES TOILET
- OFFICE AREAS

FIRST FLOOR

DEMONSTRATION OF MODERN TELEPHONES (Room 118)

Compact PABX Telephone Exchange allowing several telephone instruments to intercommunicate using modern features — also a display of modern feature telephones.

DISPLAY OF CABLES AND JOINTS (Room 118A)

Eastern Electricity have nearly 30,000 miles of underground cables installed throughout its area. These vary from 240V up to 132,000 volts. A variety of these cables and joints are displayed.

MANAGEMENT SERVICES — DISPLAY OF COMPUTER EQUIPMENT

Room 111 (Productivity Services) the Hewlett Packard Computer used as a plotter producing coloured transparencies.

Room 115A (Research and Planning) back room, various small computers showing simulation techniques plus a variety of computer games.

'MEET A METER READER' (Room 146)

Display and video showing meter reading and billing of electricity accounts and Ways to Pay. Demonstration of customer and other information held on computer and available through a Visual Display Unit (VDU).

In addition, there is a display of some of the latest advances in metering technology.

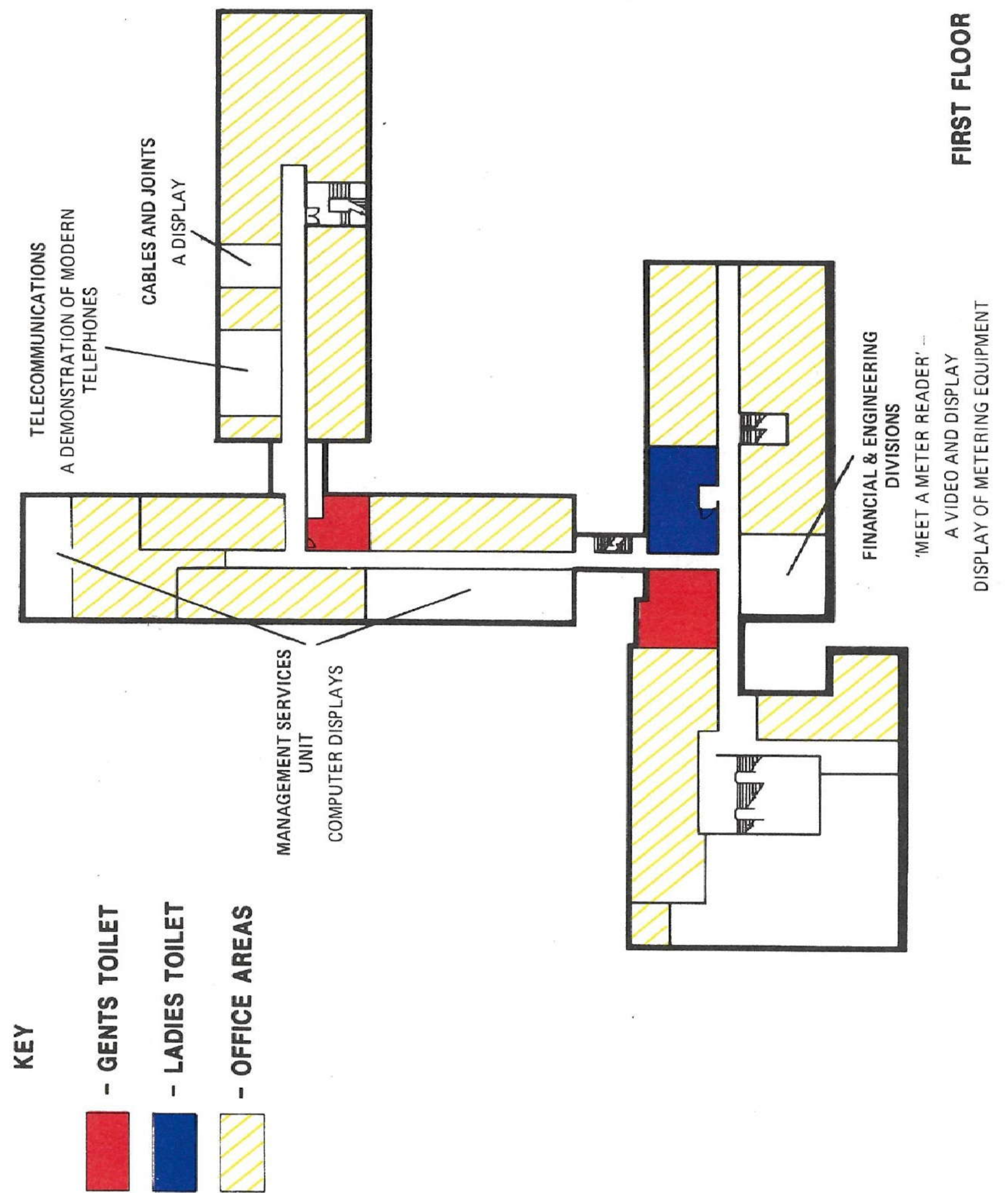

SECOND FLOOR

COMPUTER AIDED DESIGN DISPLAY — DRAWING OFFICE

The drawing office contains two computers specifically designed to produce drawings. The smaller AUTOCAD Unit is a mini computer similar to the domestic computer with the addition of a plotter. This Unit is used to produce visual aid material for sales and teaching lectures. Ultimately, it is hoped to fit this Unit with a camera processor which will produce 35mm colour slides.

The larger Intergraph Unit is much more complex. The equipment in the office is not a complete computer as the main processor is installed in our Constantine Road Office complex and connected by a telephone land line. The equipment is capable of producing working drawings and schedules used in the installation of high voltage electricity supply equipment.

Both computers have full colour capability.

